

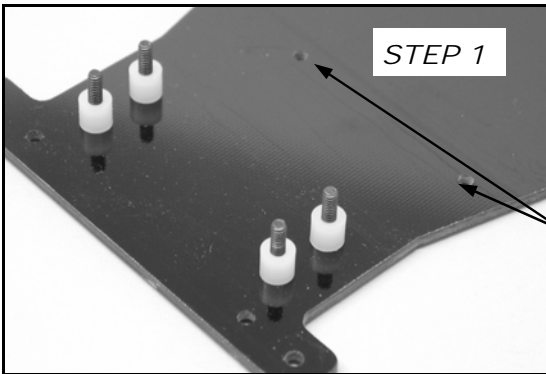

RJS2004 PRO MOD KIT LESS ELECTRICS

THANKS FOR BUYING RJ SPEED'S PRO MOD DRAG KIT. IT IS MADE FOR STRAIGHT LINE DRAG RACING AND CAN BE BROKEN IF RUN INTO SOLID OBJECTS REPEATEDLY AT HIGH SPEED. IT REQUIRES A MOTOR, BATTERY PACK, AND A TWO CHANNEL RADIO CONTROL UNIT WITH ONE SERVO AND AN ESC TO MATCH THE MOTOR YOU HAVE CHOSEN. A STANDARD SIZE OR MINI SERVO IS GOOD FOR THE STEERING. YOU WILL NEED A SMALL PAIR OF PLIERS, AND A 1/4" WRENCH OR NUTDRIVER. HEX WRENCHES TO FIT THE SOCKET HEAD SCREWS ARE INCLUDED IN THE KIT . YOU WILL ALSO NEED PAINT FOR THE LEXAN BODY AND WING.



STEP 1 REMOVE THE CHASSIS FROM BAG 1. OPEN BAG 2. INSERT FOUR 5/8" LONG SCREWS IN THE FOUR HOLES NEAR THE FRONT OF THE CHASSIS AND ADD A 1/4" SPACER ON EACH ONE, PLUS A THIN ONE ON THE FRONT TWO.

NOTE POSITION OF SERVO MOUNT HOLES CLOSER TO THE LEFT SIDE OF THE CHASSIS VIEWED FROM THE TOP.

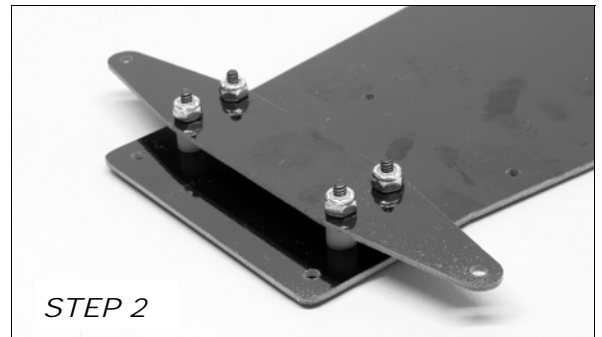

STEP 2 INSTALL THE FRONT AXLE PLATE ON THE SCREWS AND RETAIN WITH FOUR LOCKNUTS.

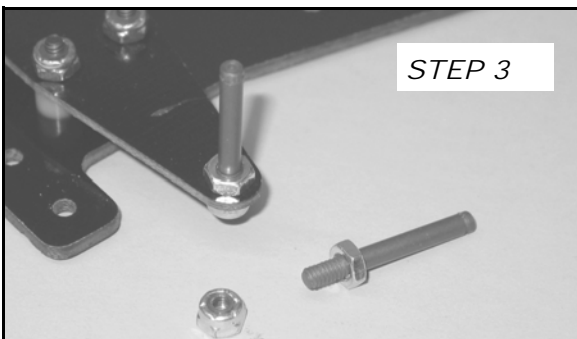

STEP 3 OPEN THE KINGPIN BAG (INSIDE BAG 2) INSTALL A THIN NUT ON EACH KINGPIN, INSERT IT INTO THE END OF THE FRONT AXLE PLATE, ADD A LOCKNUT AND TIGHTEN, REPEAT FOR THE OTHER SIDE.

STEP 4 PUT A DROP OF LIGHT OIL OR SILICONE LUBE ON EACH KINGPIN AND INSTALL A STEERING BLOCK ON EACH ONE WITH THE ANGLED PORTION POINTING IN. ADD A SPRING AND 1/8" METAL WASHER , THEN RETAIN EACH ONE WITH AN E-CLIP. SNAP AN E-CLIP ON ONE END OF EACH STUB AXLE AND PUSH THEM INTO THE STEERING BLOCKS FROM THE INSIDE.

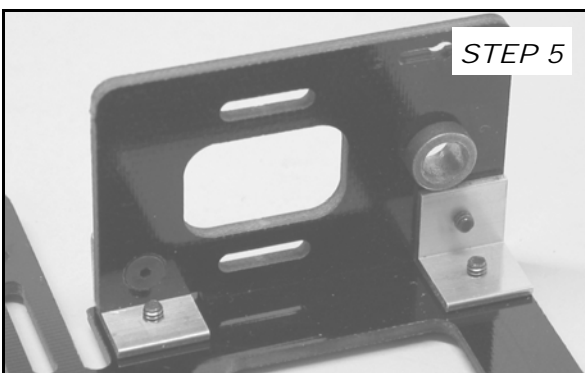
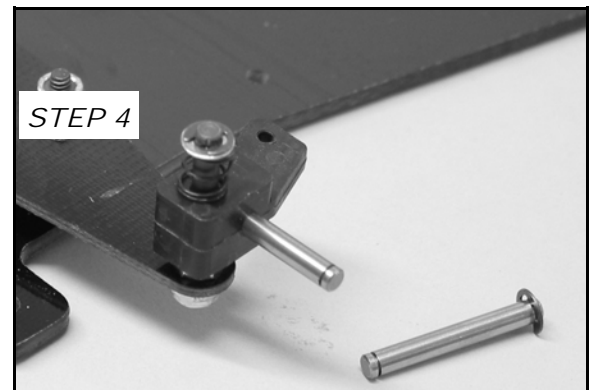

STEP 5 OPEN BAG 3 . PRESS AN OILITE BUSHING INTO THE OUTSIDE OF THE MOTOR MOUNT. ATTACH THE MOUNT TO THE CHASSIS WITH TWO ANGLE BRACKETS. NOTE THAT THE FRONT SCREW IS A FLAT HEAD AND GOES IN FROM THE INSIDE. INSTALL ALL FOUR SCREWS , THEN TIGHTEN.

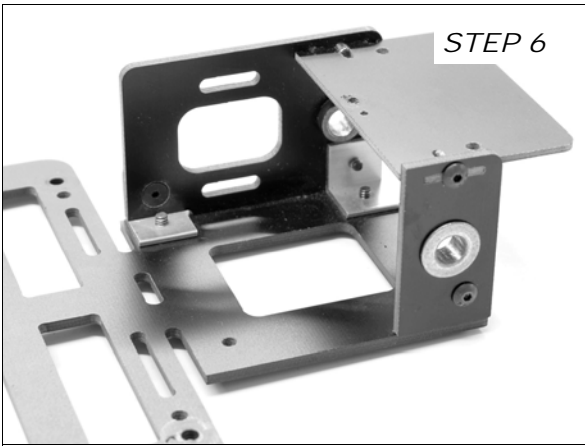

STEP 6 PRESS THE OTHER BUSHING INTO THE AXLE MOUNT. SLIDE ONE TAB ON THE SWITCH PLATE INTO THE SLOT IN THE MOTOR MOUNT, AND THE AXLE MOUNT ONTO THE OTHER TAB, AND ATTACH THE AXLE MOUNT TO THE CHASSIS WITH AN ANGLE BRACKET AND TWO 1/4" SCREWS. INSTALL 1/4" SCREWS INTO THE SLOT IN THE MOTOR AND AXLE MOUNT TO HOLD THEM TO THE SWITCH PLATE.

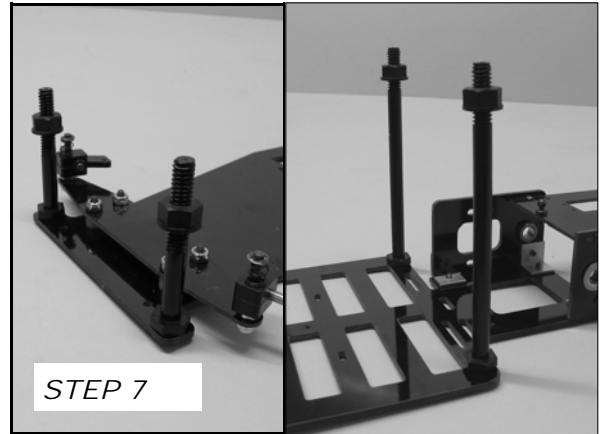

STEP 7 OPEN BAG 5 . ATTACH THE TWO SHORTER POSTS TO THE FRONT OF THE CHASSIS WITH TWO 3/8 SCREWS. ATTACH THE LONGER ONES AT THE REAR OF THE CHASSIS JUST IN FRONT OF THE REAR END. ADD POST NUTS ON EACH ONE.

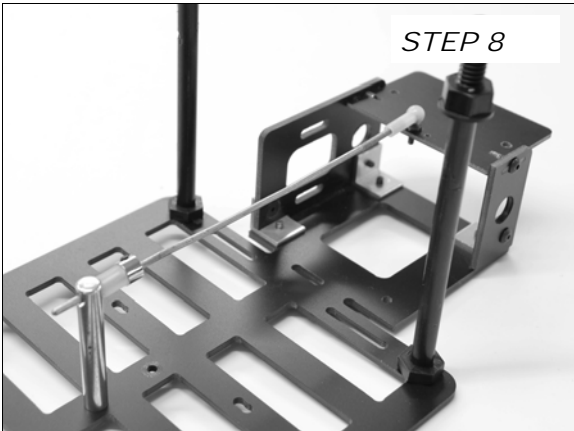

STEP 8 OPEN BAG 6 ATTACH THE SUPPORT POST TO THE CENTER OF THE CHASSIS WITH A 3/8 SCREW. THREAD THE BALL STUD INTO THE FRONT OF THE SWITCH PLATE. THREAD THE BALL CUP ONTO THE PULL ROD FROM BAG 1. SLIDE THE SET COLLAR AND SILICONE TUBE ONTO THE ROD , THEN INSERT THE ROD THRU THE HOLE NEAR THE TOP OF THE SUPPORT POST, THEN SNAP THE BALL CUP ONTO THE BALL STUD. INSTALL THE SET SCREW IN THE COLLAR, PUSH THE COLLAR AND SILICONE TUBE AGAINST THE POST AND TIGHTEN THE SET SCREW LIGHTLY. ADJUSTING THE AMOUNT OF PRESSURE ON THE POST ADJUSTS THE AMOUNT OF CHASSIS FLEX.

STEP 9 OPEN BAG 4. ATTACH THE GEAR TO THE HUB WITH TWO 3/8 BUTTON HEAD SCREWS. DO NOT OVERTIGHTEN.

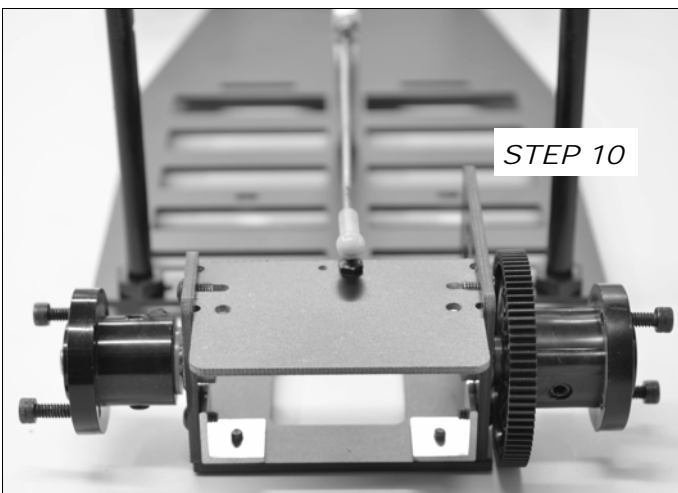

STEP 10 SLIDE THE HUB/GEAR ONTO THE AXLE AND RETAIN WITH TWO 10-32 SET SCREWS. TIGHTEN EACH CAREFULLY. PLASTIC CAN BE STRIPPED IF OVERTIGHTENED. INSTALL A NYLON AXLE SPACER ON THE AXLE, SLIDE THE AXLE THRU THE BUSHINGS, ADD TWO SPACERS AND ADD THE LEFT HUB. INSTALL TWO SET-SCREWS AND TIGHTEN CAREFULLY, ONE THEN THE OTHER UNTIL THEY ARE FAIRLY TIGHT. TIGHTENING ONE TOO MUCH AT A TIME WILL CAUSE THE TIRE AND HUB TO RUN OUT OF ROUND.

SUGGESTION: TIGHTEN THE SETSCREWS LIGHTLY TO MAKE A MARK ON THE AXLE , THEN REMOVE THE HUBS AND GRIND OR FILE A FLAT SPOT ON THE AXLE FOR THE SETSCREW TO HIT. THEN THEY WILL HOLD WITH LESS TIGHTENING.

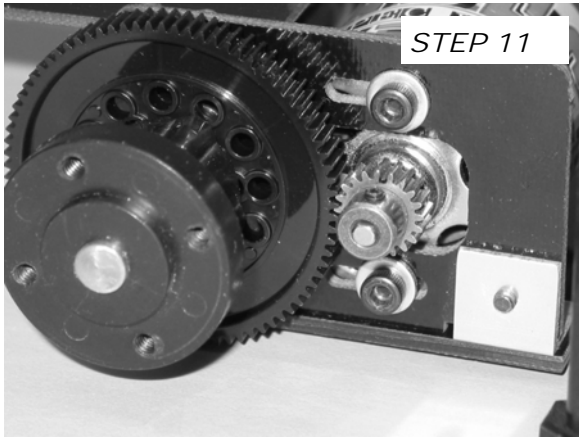

STEP 11 OPEN BAG 9 INSTALL THE PINION GEAR ONTO THE MOTOR YOU HAVE CHOSEN. INSTALL THE MOTOR WITH TWO M3 SCREWS AND WASHERS. MAKE SURE THE PINION IS LINED UP WITH THE AXLE GEAR, ADJUST THE MOTOR SO THERE IS A SMALL AMOUNT OF PLAY IN THE GEARS , AND TIGHTEN THE SCREWS. TURN THE AXLE A COUPLE OF TIMES TO RECHECK.

STEP 12 OPEN BAG 7 PRESS A BUSHING INTO EACH SIDE OF EACH FRONT WHEEL AND STRETCH AN O-RING ON EACH ONE. PUT A SMALL DROP OF LIGHT OIL ON EACH FRONT AXLE , INSTALL THE WHEELS AND RETAIN WITH E-CLIPS.

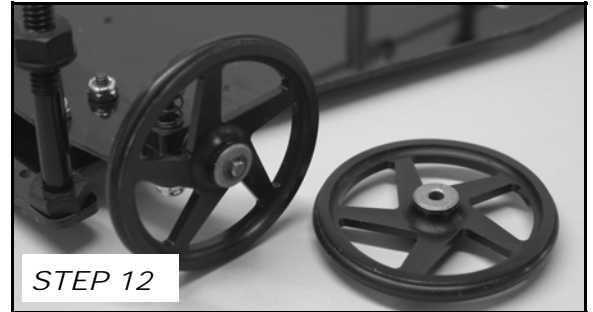

STEP 13 INSTALL THE REAR TIRES FROM BAG 8 WITH TWO 3/8 CAP SCREWS EACH FROM BAG 4.

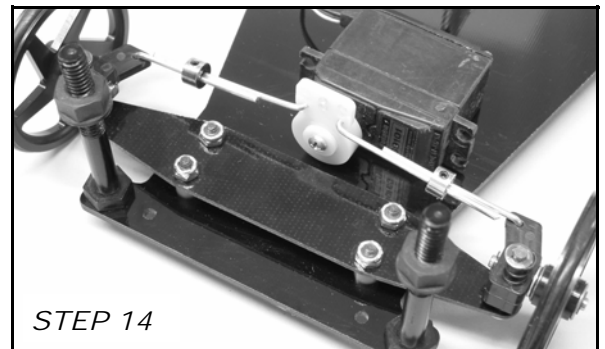

STEP 14 ATTACH YOUR STEERING SERVO TO THE CHASSIS WITH SERVO TAPE, POSTS, OR SCREWS IF YOUR SERVO HAS SIDE MOUNTS. INSTALL PREBENT LINKS AND ATTACH WITH 1/8 COLLARS AND SETSCREWS. CUT THE LENGTH OF THE LINKS AS NECESSARY.

STEP 15 MOUNT YOUR RECEIVER AND ESC ON THE CHASSIS BEHIND THE STEERING SERVO WITH SERVO TAPE PROVIDED. YOU CAN ALSO MOUNT YOUR ESC IN THE PLATE BEHIND THE MOTOR AND AXLE MOUNTS IF YOUR ESC WIRE WILL REACH THE RECEIVER. EXTENSION WIRES ARE AVAILABLE FROM SOME RADIO MANUFACTURERS. THIS WILL ADD WEIGHT OVER THE REAR TIRES FOR BETTER TRACTION IF NEEDED, ESPECIALLY ON UNPREPARED SURFACES SUCH AS PARKING LOTS.

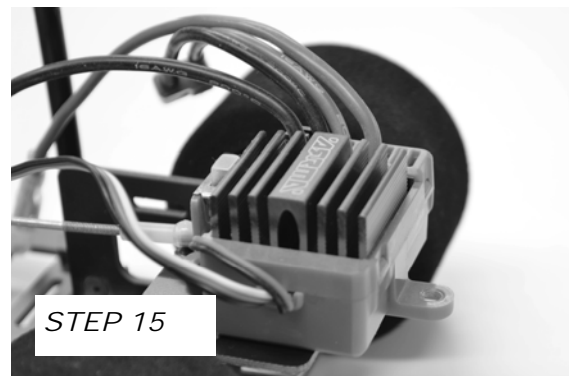

STEP 16 INSTALL YOUR BATTERY PACK AT THE REAR OF THE CHASSIS WITH TIE STRAPS INCLUDED. IF YOU ARE RUNNING ON CLEAN PREPARED SURFACES, YOU MAY NEED TO MOVE IT FORWARD AS NECESSARY.

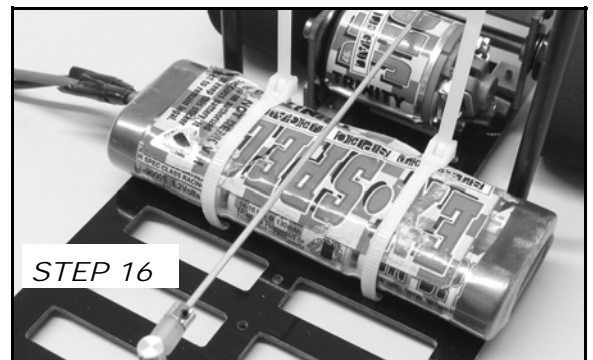

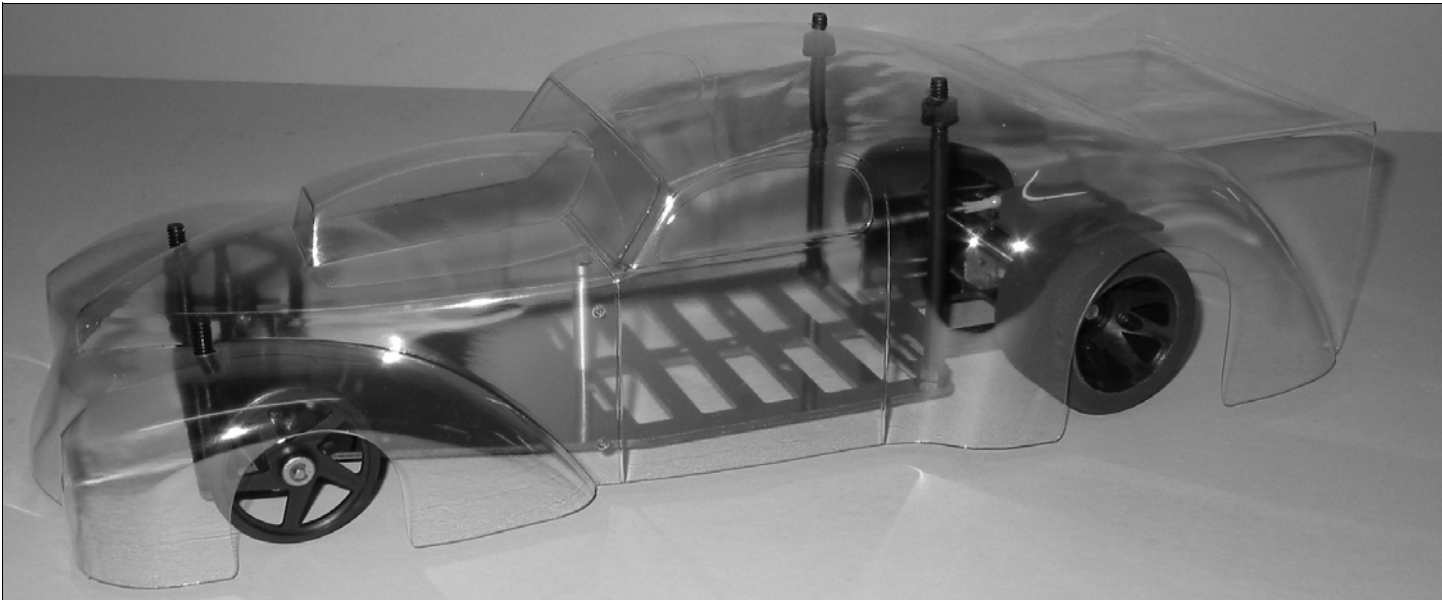

STEP 17 TRIM OUT YOUR BODY, SET OVER THE CHASSIS AND MARK THE OUTSIDE FOR POST HOLES AND WHEEL CUTOUTS, PAINT THE BODY, CUT OUT AND DRILL MOUNT HOLES, MOUNT THE BODY, THEN PEEL THE PROTECTIVE FILM. WE HAVE PROVIDED A LEXAN SHEET AND TEMPLATES SO YOU CAN ADD SIDEDAMS AND A REAR DECK EXTENSION LIKE THE ONES ON THE BOX LABEL. LAY THE LEXAN SHEET OVER THE TEMPLAT AND SCORE ALONG THE LINES WITH YOUR HOBBY KNIFE. PEEL THE PROTECTIVE FILM ON THE OPPOSITE SIDE OF THE SHEET AND PAINT THE LEXAN AS YOU WISH. BEND THE LEXAN AWAY FROM THE CUT SIDE UNTIL IT SNAPS. ATTACH THE PARTS TO YOUR BODY WITH SCREWS OR DOUBLE SIDED TAPE. CHARGE YOUR BATTERY, CHECK OUT YOUR RADIO SETTINGS AND ADJUSTMENTS AND THEN *GO OUT AND HAVE SOME FUN!* YOU CAN INCREASE THE REAR TRACTION BY WIPING YOUR REAR TIRES WITH WD-40. IT WILL CLEAN AND SOFTEN THE RUBBER. YOU CAN ALSO USE SIMPLE GREEN CLEANER TO SOFTEN THE REAR TIRES AND MAKE THEM TACKY. REPLACEMENT PARTS AND ACCESSORIES ARE AVAILABLE THRU YOUR LOCAL HOBBY SHOP.

SOME CURRENTLY AVAILABLE ACCESSORIES ARE SHOWN BELOW:



WE HAVE TWO WHEELIE BARS THAT BOLT DIRECTLY UNDER THE REAR END OF OUR DRAG KITS.
5030- 5" MODEL & 5037-7" (SHOWN)

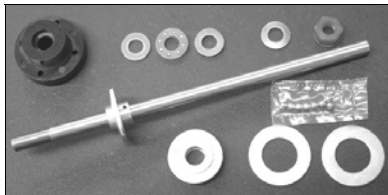

OUR 5732 DIFF KIT WILL HELP YOU GET OFF THE LINE ON UNPREPARED SURFACES BY ALLOWING YOU TO ADJUST IN A LITTLE SLIP AS NECESSARY.



5136 NARROW FRONT AXLE PLATE FOR SOME BODY STYLES .40 NARROWER THAN 5134.

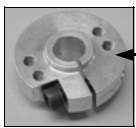

5320 ALUMINUM CLAMP HUB HOLDS THE GEAR AND A 2 BOLT 1/12 SCALE WHEEL. USE THE SAME FOR THE LEFT SIDE.

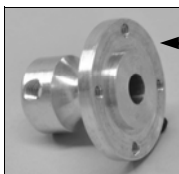

5314 ALUMINUM SET SCREW HUB FOR THE LEFT SIDE.

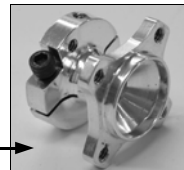

5321 ALUMINUM CLAMP HUB HOLDS THE GEAR AND RIGHT WHEEL. USES 4-40 WHEEL SCREWS (INCLUDED).

5322 .5 WIDE LEFT SIDE CLAMP HUB ALSO AVAILABLE

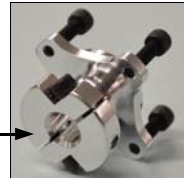

5172 ALUMINUM MOTOR PLATE AND AXLE MOUNT KIT INCLUDES ADJUSTABLE AXLE HEIGHT.

1056 D STYLE PRO STOCK BODY. MINIMUM DRAG. ADD SMALL LIP FOR MORE REAR DOWNFORCE.



SEE www.rjspeed.com FOR A LISTING OF NEW PRODUCTS AND ACCESSORIES

SUGGESTED TEMPLATES FOR SIDEDAMS AND REAR DECK EXTENSIONS ARE SHOWN BELOW. LAY LEXAN SHEET OVER TEMPLATES BELOW OR DESIGN YOUR OWN.THEY CAN BE PAINTED TO MATCH YOUR BODY OR LEFT CLEAR.

AFTER CUTTING THEM OUT, FOLD THE REAR DECK EXTENSION ON THE DOTTED LINES SO YOU CAN ATTACH IT TO THE SIDE DAMS IN ADDITION TO THE REAR OF THE BODY FOR STRENGTH. ATTACH THEM TO THE BODY WITH SCREWS OR DOUBLE BACK TAPE.

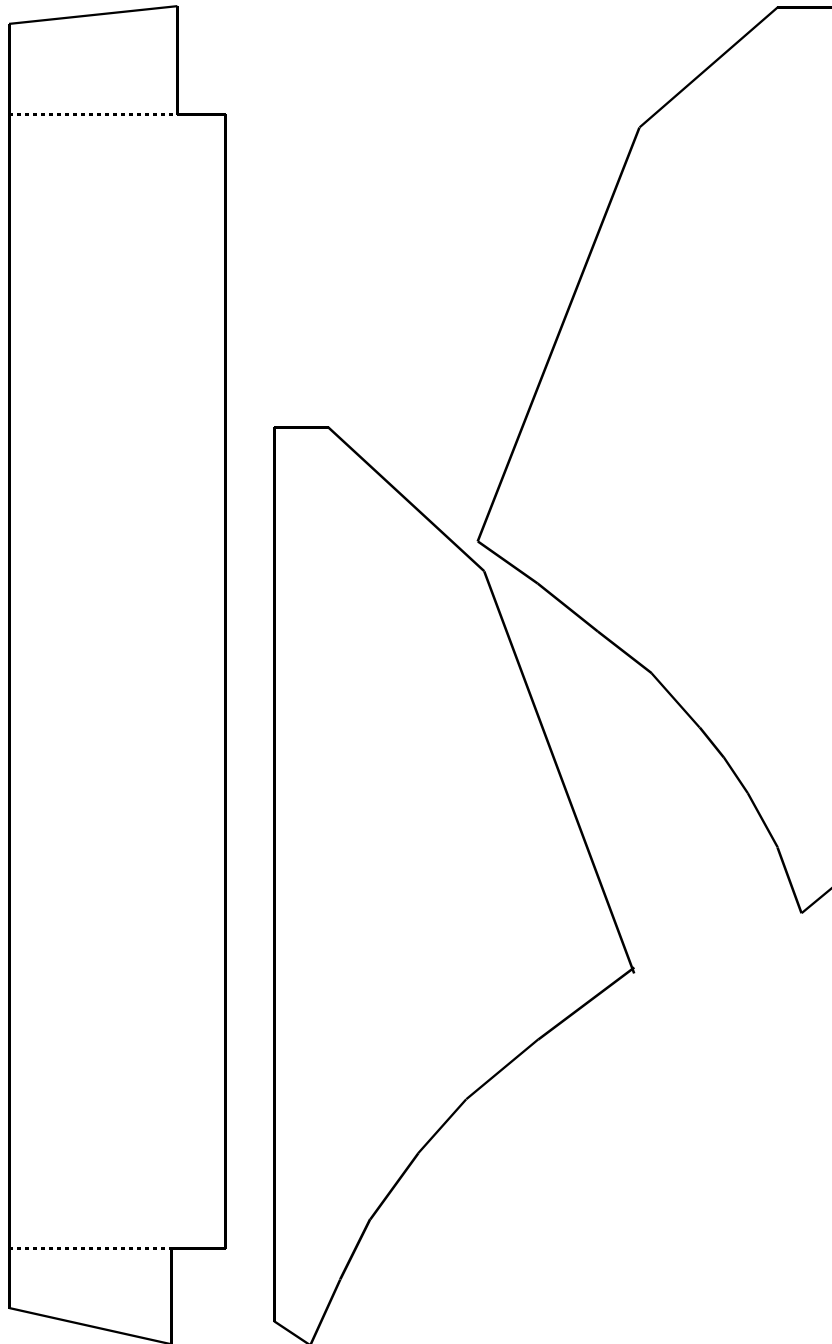



2004 PRO MOD KIT

- 1020 PRO MOD BODY
- 2502 2.0" O-RING FRONTS (BLACK)
- 2510 1.5 WIDE REAR TIRES, STD.
- 5038 PRO MOD CHASSIS
- 5167 MOTOR MOUNT PLATE
- 5168 L.AXLE MOUNT PLATE
- 5169 SWITCH PLATE
- 5134 FRONT AXLE PLATE
- 5228 FRONT SPRING
- 5282 ANGLE BRACKET, TAPPED(4)
- 5311 SET SCREW HUB
- 5312 GEAR / WHEEL HUB
- 5351 STEERING BLOCKS (2)
- 5377 KINGPIN (2)
- 5363 E-CLIP AXLE, .825 LONG (2)
- 5747 REAR AXLE, STAINLESS STEEL

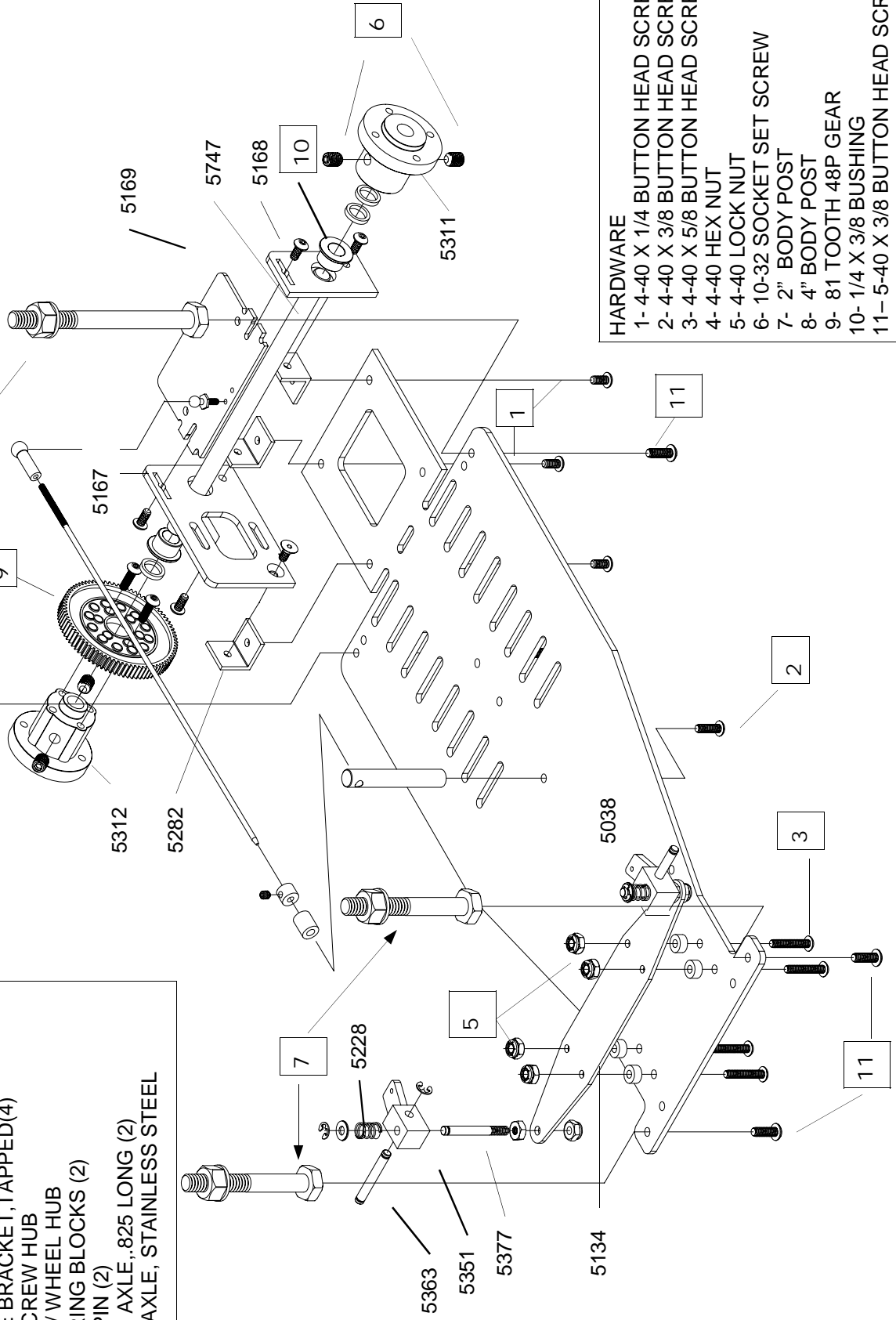

- HARDWARE**
- 1- 4-40 X 1/4 BUTTON HEAD SCREW
 - 2- 4-40 X 3/8 BUTTON HEAD SCREW
 - 3- 4-40 X 5/8 BUTTON HEAD SCREW
 - 4- 4-40 HEX NUT
 - 5- 4-40 LOCK NUT
 - 6- 10-32 SOCKET SET SCREW
 - 7- 2" BODY POST
 - 8- 4" BODY POST
 - 9- 81 TOOTH 48P GEAR
 - 10- 1/4 X 3/8 BUSHING
 - 11- 5-40 X 3/8 BUTTON HEAD SCREW