



2032 3 in 1 CLASSIC SPRINT CAR KIT

THANKS FOR BUYING THE RJ SPEED CLASSIC SPRINTER KIT. IT IS COMPLETE LESS ELECTRICS, AND MADE FOR CARPET OR PAVEMENT RACING. IT REQUIRES A 540 OR 550 SIZE MOTOR, 4 OR 6 CELL BATTERY PACK, TWO CHANNEL RADIO WITH ESC, AND A SERVO SAVER TO FIT THE BRAND OF RADIO YOU HAVE CHOSEN. THE TOOLS YOU WILL NEED ARE A SMALL PAIR OF PLIERS, A 1/4 " SOCKET OR WRENCH, AND A 7/16 " SOCKET WRENCH FOR THE DIFFERENTIAL. HEX WRENCHES TO FIT THE SOCKET HEAD SCREWS ARE INCLUDED IN THE KIT. YOU WILL ALSO NEED PAINT MADE FOR LEXAN FOR THE BODY PARTS . REFER TO THE TEXT AND PICTURES FOR EACH STEP , AND ALSO THE EXPLODED VIEW DRAWING FOR THE CHASSIS ASSEMBLY AND PARTS REFERENCE AND THE BODY TRIM AND ASSEMBLY DRAWINGS.

IT IS BEST TO READ EACH STEP THROUGH, LOOK AT THE PICTURES, DRAWINGS, AND PARTS , THEN DO THE ASSEMBLY STEP.

YOUR KIT CONTAINS THE FOLLOWING:

- BAG J1 CHASSIS KIT
- BAG L2 REAR AXLE PARTS
- BAG L4 FRONT TIRES
- BAG L5 REAR TIRES

- CLASSIC INDY ROADSTER AND CHAMP CAR BODY KITS
- INSTRUCTION PKG. WITH SERVO TAPE AND RJ SPEED DECALS

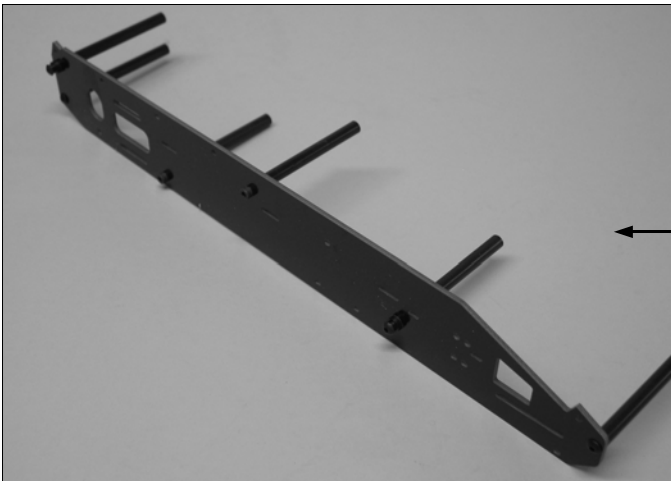
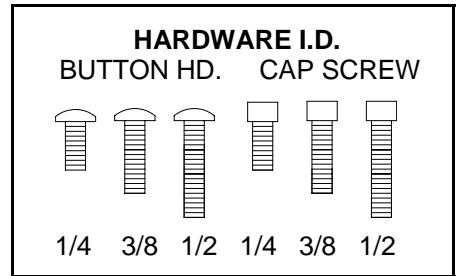

STEP 1 OPEN BAG J1 . ATTACH SIX CHASSIS SPACERS TO EITHER CHASSIS SIDE . USE 1/2" BUTTON HEAD SCREWS WITH 2434 MOUNTS ON THEM ON THE TOP REAR AND 2ND FROM THE FRONT. USE 3/8 LONG BUTTON HEAD SCREWS ON THE BOTTOM REAR AND FRONT SPACERS. USE 3/8 CAP SCREWS ON THE TWO REMAINING TWO SPACERS.

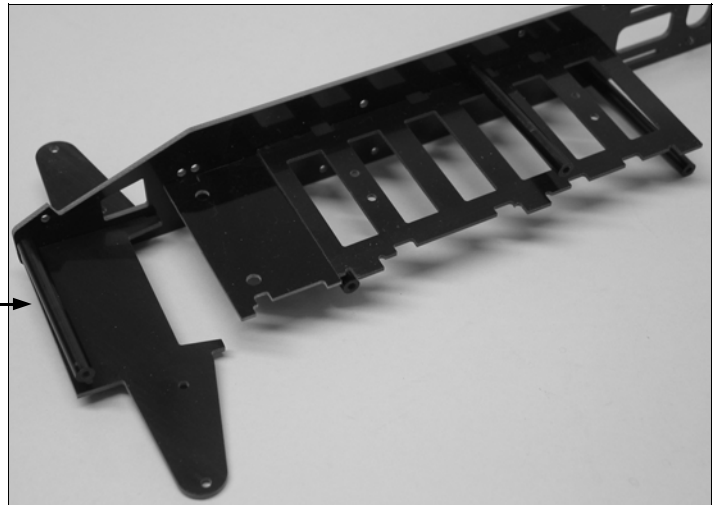

STEP 2 INSTALL THE FRONT AXLE PLATE, SERVO PLATE , AND BATTERY TRAY IN THE CHASSIS SIDE .

STEP 3 INSTALL THE 2ND CHASSIS SIDE USING THE SAME LAYOUT AS STEP 1 FOR SCREW TYPES AND PLACEMENT OF THE 2434 MOUNTS.



STEP 4 OPEN THE STEERING BAG FROM BAG J1 AND THREAD A JAM NUT ON EACH 5377 KINGPIN, INSERT INTO EACH END OF THE FRONT AXLE PLATE, AND ADD A 7207 LOCKNUT ON EACH ONE.

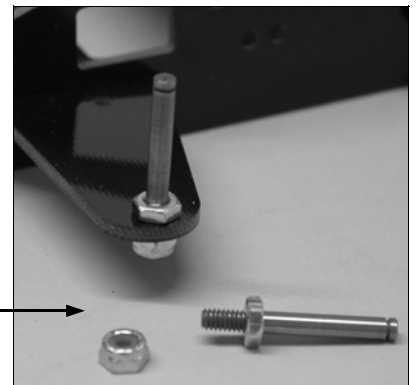

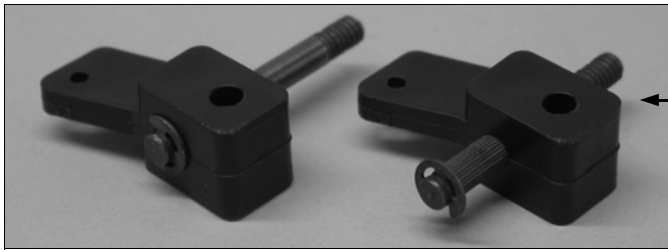

STEP 5 PRESS A 5364 STUB AXLE INTO EACH 5351 STEERING BLOCK AND RETAIN WITH A 5221 E-CLIP.

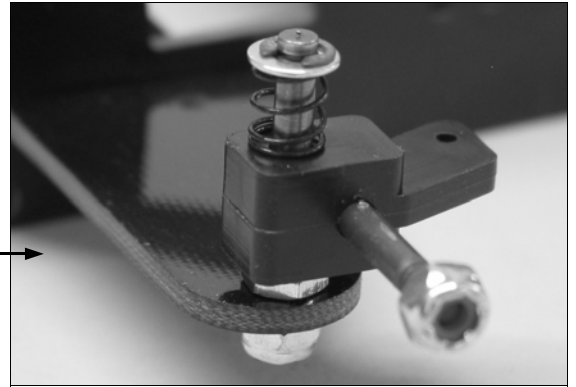

STEP 6 LUBE EACH KINGPIN, SLIDE THE STEERING BLOCK ON, ADD A 5228 SPRING, WASHER, AND E-CLIP.

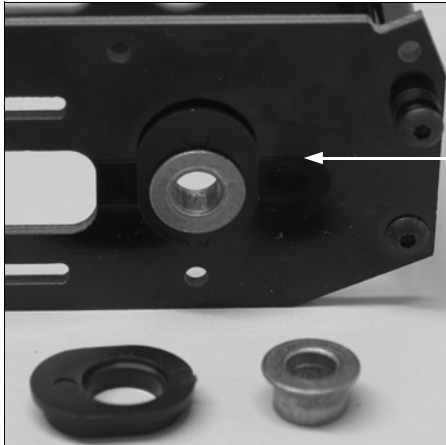

STEP 7 INSTALL THE 5188 RIDE HEIGHT ADAPTORS FROM BAG L2 AND ADD THE 5452 REAR BUSHINGS.

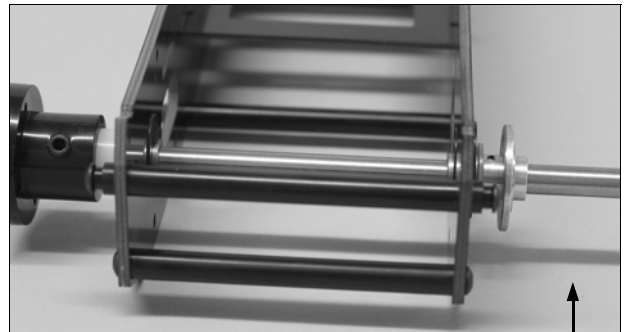
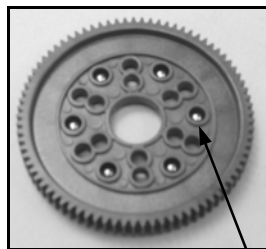

STEP 8 SNAP A DIFF BALL INTO EVERY OTHER HOLE IN THE OUTSIDE ROW OF THE GEAR. LUBE EACH ONE WITH A LITTLE THICK SILICONE OR GREASE.

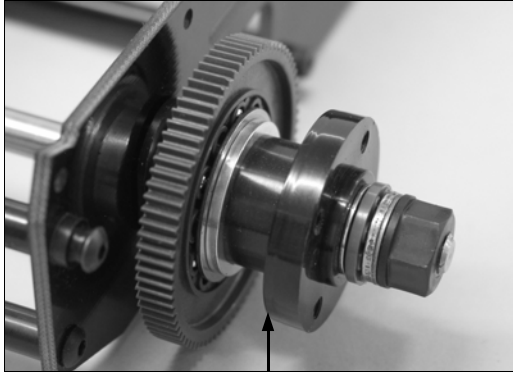

STEP 9 INSTALL A THIN NYLON AXLE WASHER ON THE AXLE, SLIDE THE AXLE THRU THE BUSHINGS, THEN ADD THE 1/4" AXLE SPACER AND 5311 HUB WITH SETSCREWS. LEAVE A SMALL AMOUNT OF SIDEPLAY IN THE AXLE. ADD A DROP OF LIGHT OIL INSIDE EACH BUSHING. TIGHTEN EACH SETSCREW A LITTLE A TIME TO KEEP FROM WARPING THE HUB. YOU CAN FILE A FLAT SPOT ON THE AXLE WHERE EACH SETSCREW HITS TO MAKE IT MORE SECURE. MAKE SURE THE AXLE SPINS FREELY IN THE BUSHINGS.

STEP 10 ASSEMBLE THE DIFF BY INSTALLING ONE DRIVE RING ON THE AXLE, THE GEAR, SECOND DRIVE RING AND ALUM. ADAPTOR, 5309 HUB, THIN STEEL WASHER, THRUST BEARING, THICK STEEL WASHER, CONE WASHER, AND DIFF NUT. TIGHTEN THE NUT TO REMOVE SIDEPLAY, AND ADJUST UNTIL YOU CAN HOLD BOTH HUBS AND THE GEAR DOES NOT SLIP EASILY.

STEP 11 INSTALL THE MOTOR YOU HAVE PURCHASED WITH M3 SCREWS AND WASHERS FROM BAG H3. INSTALL THE GEAR WITH THE SETSCREW AND MAKE SURE IT LINES UP WITH THE DIFF GEAR. SLIDE THE MOTOR BACK UNTIL YOU HAVE A VERY SMALL AMOUNT OF PLAY BETWEEN THE GEARS. TIGHTEN THE MOTOR SCREWS, TURN THE AXLE A COUPLE OF TIMES, CHECK THE GEAR MESH, AND READJUST IF NECESSARY.

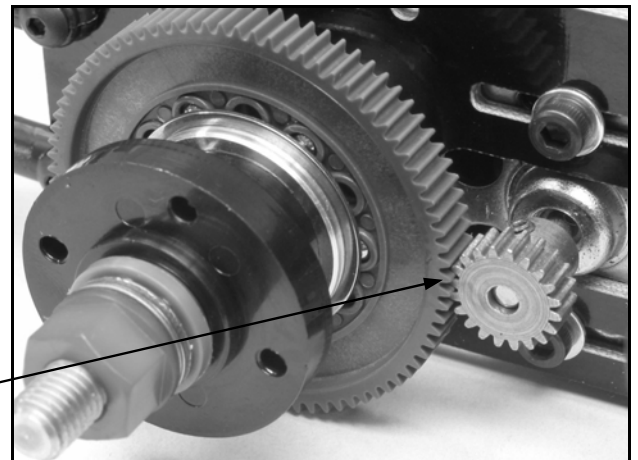

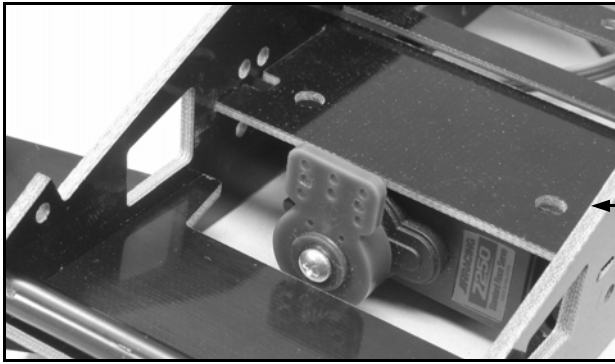

STEP 12 INSTALL YOUR SERVO SAVER ON THE SERVO AND ATTACH THE SERVO UNDER THE SERVO PLATE WITH FOAM TAPE PROVIDED. GET THE SERVO SAVER AS CLOSE TO THE CENTER AS POSSIBLE. MAKE SURE TO WIPE THE SERVO AND SERVO PLATE WITH A DRY CLOTH BEFORE APPLYING THE TAPE.

STEP 13 INSTALL THE STEERING LINKAGE FROM BAG H3. INSTALL A LONG LINK IN EACH STEERING BLOCK AND TWO SHORT ONES IN THE SERVO SAVER. USE THE COLLARS AND SET SCREWS TO ATTACH THE RODS TOGETHER AFTER ALIGNING THE STEERING.

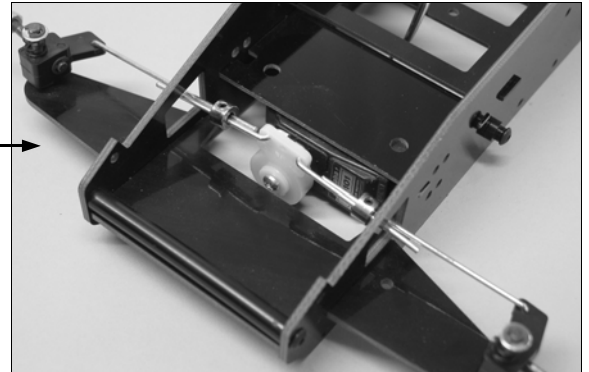

STEP 14 INSTALL YOUR SPEED CONTROL AND RECEIVER ON TOP OF THE BATTERY TRAY WITH FOAM TAPE. MAKE SURE TO LEAVE ROOM TO USE TIE STRAPS IN A COUPLE OF THE SLOTS AT THE EDGE OF THE TRAY TO HOLD THE BATTERY PACK UNDER IT.

STEP 15 IF YOU HAVE A RADIO THAT NEEDS IT, INSTALL THE ANTENNA TUBE ON THE INSIDE OF THE CHASSIS THRU THE SERVO PLATE WITH TWO SMALL TIE STRAPS. ROUTE YOUR ANTENNA WIRE THRU THE TUBE FROM THE BOTTOM. PLUG YOUR SPEED CONTROL AND SERVO INTO THE RECEIVER, GATHER ALL THE EXCESS WIRE (INCLUDING ANTENNA WIRE) AND TAPE IT IN PLACE NEAR THE RECEIVER. SOLDER OR CONNECT YOUR SPEED CONTROL WIRES TO THE MOTOR.

YOU SHOULD CHARGE YOUR BATTERY AND TEST YOUR RADIO FUNCTIONS AND MAKE ADJUSTMENTS NOW.

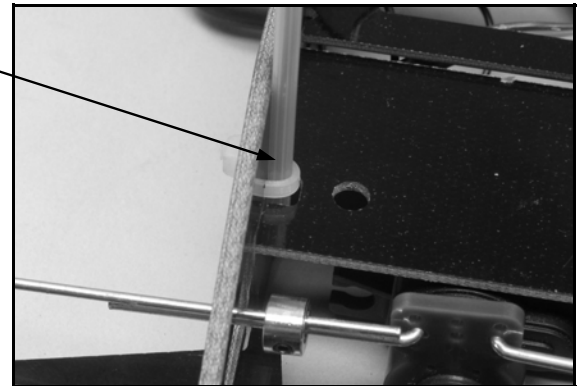

STEP 16 INSTALL YOUR BATTERY PACK UNDER THE TRAY WITH A TIE STRAP. YOU SHOULD HAVE ROOM TO MOUNT YOUR SWITCH NEXT TO IT WITH SERVO TAPE SO YOU CAN TURN THE CAR ON AND OFF WITHOUT REMOVING THE BODY. YOU CAN ALSO MOUNT THE SWITCH NEXT TO THE SERVO IF YOU HAVE ROOM.

STEP 17 PRESS THE BUSHINGS FROM BAG H3 INTO EACH SIDE OF EACH FRONT WHEEL FROM BAG L4. LUBE THE FRONT AXLES WITH LIGHT OIL AND INSTALL THE FRONT WHEELS. ADD LOCKNUTS FROM THE STEERING BAG TO HOLD THEM ON. TIGHTEN THEM LIGHTLY, THEN BACK THEM OFF UNTIL THE WHEELS SPIN FREELY. INSTALL THE REAR TIRES FROM BAG L5 TO THE REAR HUBS WITH TWO 3/8 CAP SCREWS EACH FROM THE DIFF BAG. THE TIRES IN YOUR KIT MAY VARY FROM THE ONES SHOWN. THEY WILL BE OF THE SAME OR BETTER QUALITY.

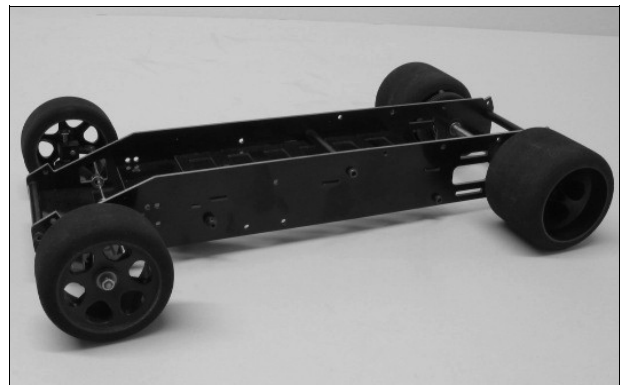

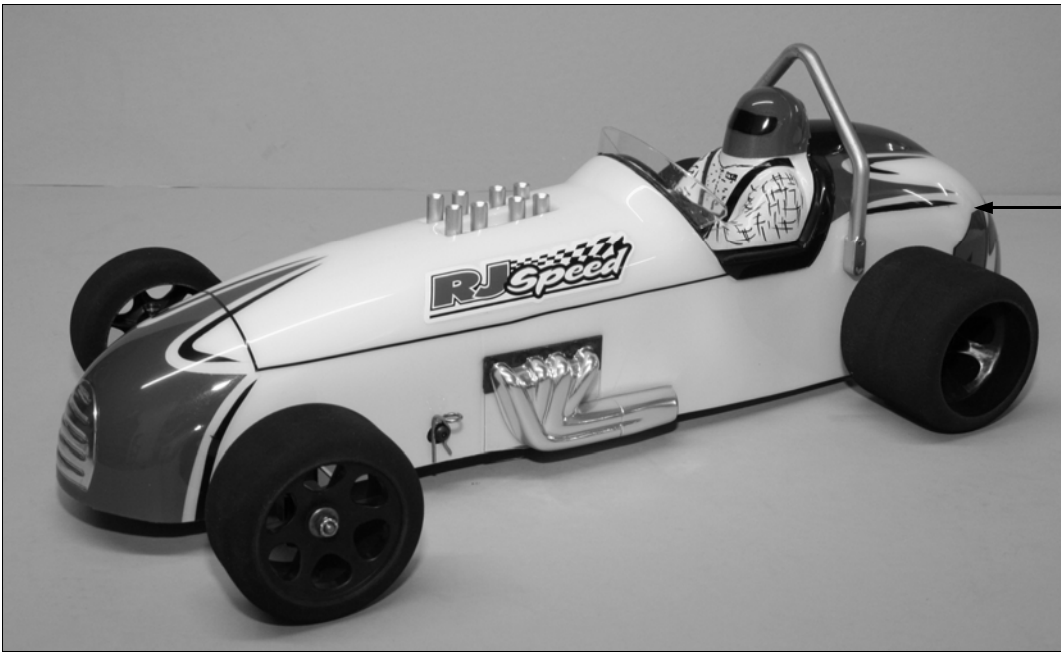

NOTE THAT THE TWO DRIVER FIGURES ARE DIFFERENT. ONE IS MARKED ROADSTER TO GO ON THE OPEN COCKPIT BODY. USE A SMALL PC. OF SERVO TAPE IN THE LAP AREA TO ATTACH IT.

THE OTHER ONE IS SLIGHTLY NARROWER TO FIT INSIDE THE ROLL CAGE. USE TAPE TO ATTACH THE SIDES TO THE BODY.

STEP 18 REFER TO THE BODY DRAWINGS FOR TRIMMING AND MOUNTING OF THE ACCESSORY PARTS. PAINT THE BODIES ,HEADERS AND WING FROM THE INSIDE. PAINT THE DRIVER HELMET FROM THE INSIDE AND THE DRIVER SUIT ON THE OUTSIDE SO IT WILL HAVE A "FLAT" APPEARANCE. WE RECOMMEND ALCLAD "CHROME " PAINT FOR THE HEADERS. YOU CAN ALSO SPRAY THE ROLL BAR AND INJECTORS TO GIVE THEM MORE OF A CHROME APPEARANCE. LAY THE LEXAN SHEET FROM THE INSTR. PACKAGE OVER THE WING MOUNT TEMPLAT AND MARK IT FOR TRIMMING AND BENDING. BEND AS SHOWN IN THE BODY DRAWING. THE ENDS OVERLAP TO MAKE AN ADJUSTABLE ANGLE FOR THE WING . YOU CAN TAPE THEM TOGETHER OR DRILL A COUPLE OF SETS OF HOLES AND USE SMALL SCREWS TO ATTACH THEM, AND BE ABLE TO CHANGE THE ANGLE. SERVO TAPE THE MOUNT TO THE WING AND USE THE SAME OR VELCRO (NOT INCLUDED) TO ATTACH THE WING TO THE BODY FOR EASY REMOVAL.

REAR
WING MOUNT TEMPLAT
FRONT
REAR



NOW TAKE YOUR CAR OUT AND HAVE SOME RC FUN . RJ SPEED CARS ARE MADE OF QUALITY PARTS, BUT CAN BE BROKEN IF RUN INTO SOLID OBJECTS AT HIGH SPEED. REPLACEMENT PARTS AND ACCESSORIES ARE AVAIL-ABLE THRU YOUR LO-CAL HOBBY SHOP.

www.rjspeed.com



2032 CLASSIC SPRINT CAR

- REPLACEMENT PARTS**
- 2520 FRONT SPEC TIRES (2)
 - 2530 REAR SPEC TIRES (2)
 - 5060 CHASSIS SIDE
 - 5062 RADIO TRAY
 - 5063 SERVO PLATE
 - 5188 AXLE HEIGHT ADAPT (2 PR)
 - 5221 E-CLIPS (6)
 - 5228 FRONT SPRINGS (2)
 - 5244 FRONT AXLE PLATE
 - 5245 CHASSIS SPACERS (6)
 - 5308 STEERING LINKAGE
 - 5351 STEERING BLOCKS (2)
 - 5364 STUB AXLES (2)
 - 5377 KINGPINS (2)
 - 5452 REAR BUSHINGS (2)
 - 5457 FRONT BUSHINGS (4)

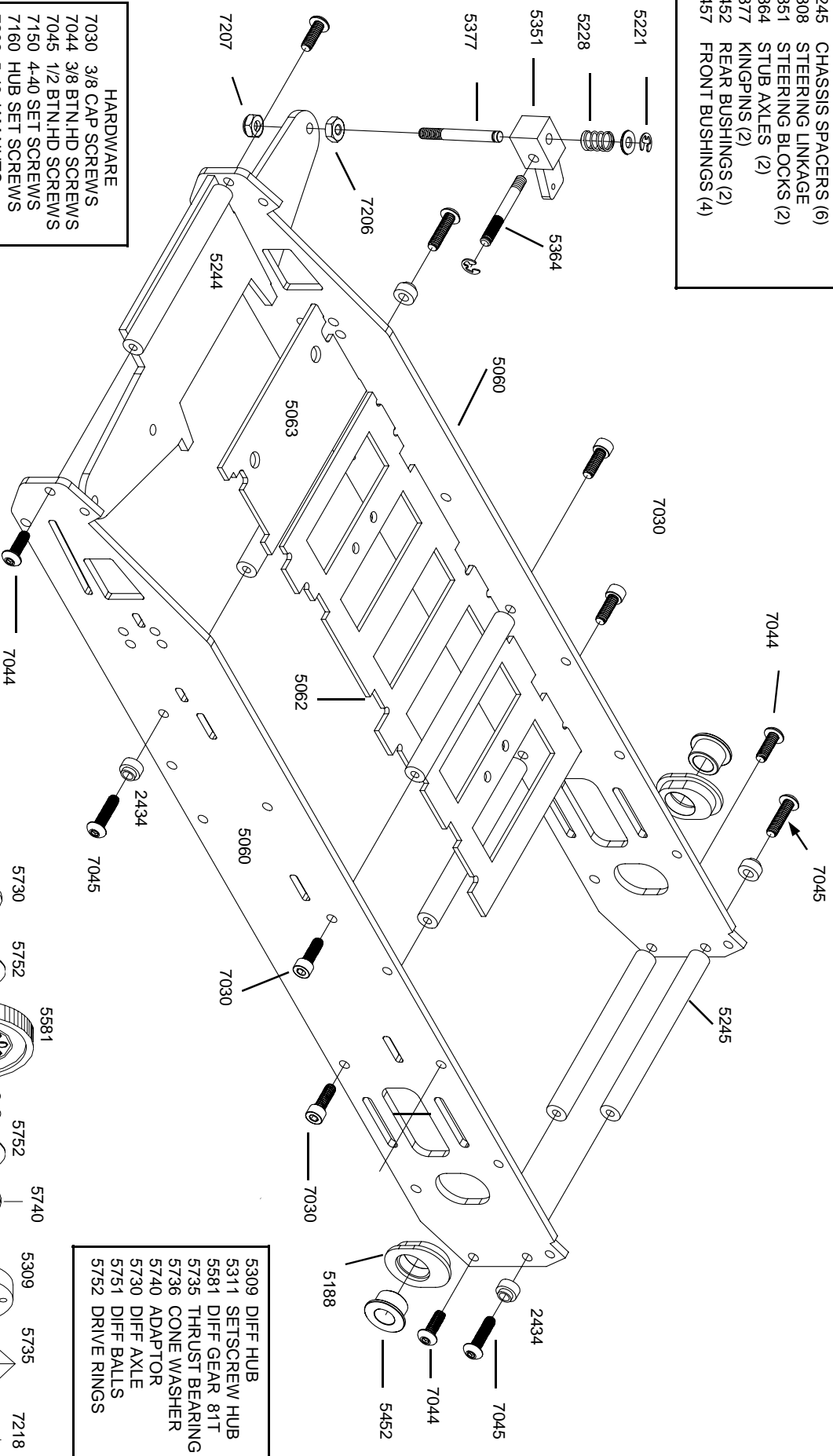

- HARDWARE**
- 7030 3/8 CAP SCREWS
 - 7044 3/8 BTN.HD SCREWS
 - 7045 1/2 BTN.HD SCREWS
 - 7150 4-40 SET SCREWS
 - 7160 HUB SET SCREWS
 - 7206 5-40 JAM NUTS
 - 7207 5-40 LOCK NUTS
 - 7218 RED DIFF NUTS

- 1047 INDY ROADSTER BODY KIT
- 1048 CLASSIC CHAMP CAR BODY KIT
- 2434 BODY MOUNTS (4 W/SCREWS)

- 5309 DIFF HUB
- 5311 SETSCREW HUB
- 5581 DIFF GEAR 81T
- 5735 THRUST BEARING
- 5736 CONE WASHER
- 5740 ADAPTOR
- 5730 DIFF AXLE
- 5751 DIFF BALLS
- 5752 DRIVE RINGS

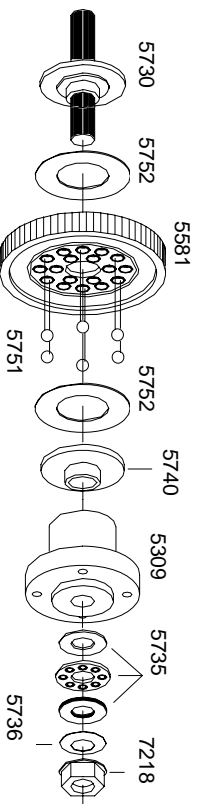

1047 INDY ROADSTER

PAINT THE BODY AND DRIVER. TRIM OUT AS SHOWN.
DRILL BODY MOUNT HOLES 1/4".

DRILL FOUR 1/8 HOLES AS MARKED AND ATTACH THE
ROLL BAR WITH FOUR SMALL SCREWS PROVIDED.

MOUNT THE WINDSHIELD, HEADERS, DRIVER, AND IN-
JECTORS WITH DOUBLE BACKED TAPE.

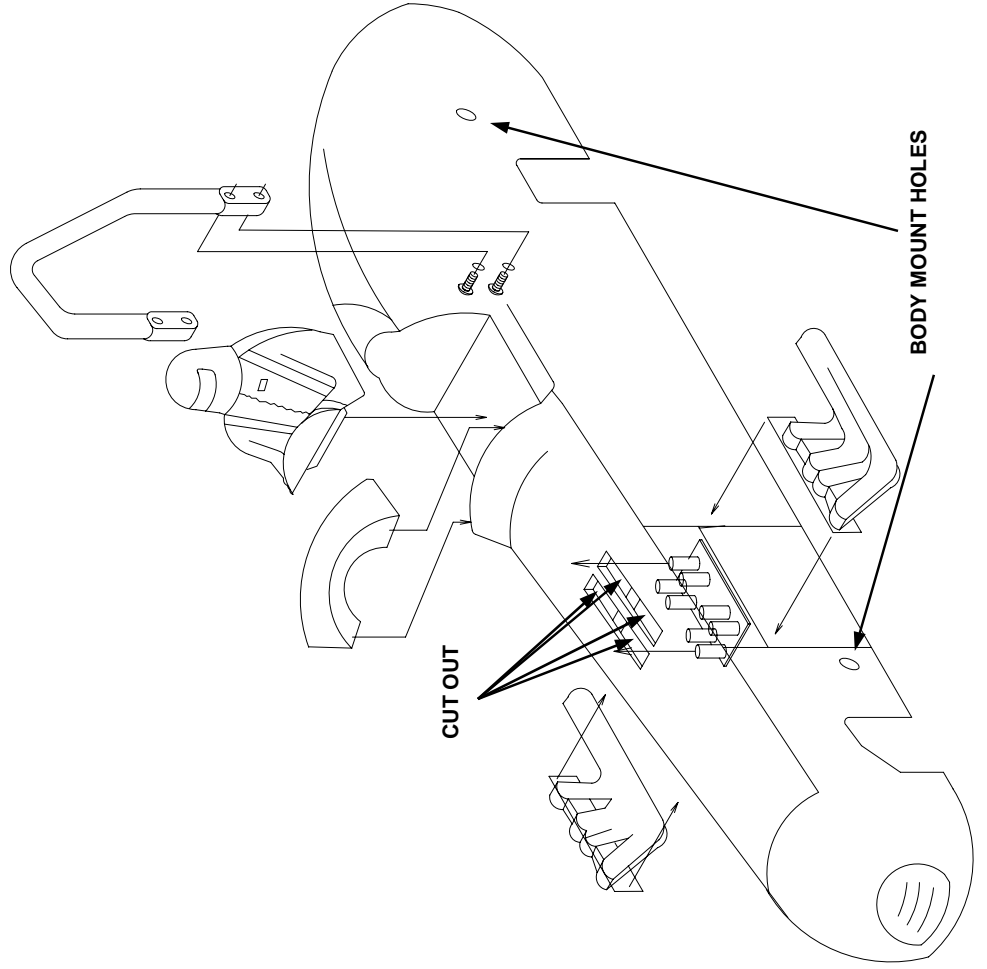

1048 CLASSIC CHAMP CAR

PAINT THE BODY AND DRIVER, AND WING IF YOU ARE GOING TO
USE IT. TRIM OUT AS SHOWN. DRILL BODY MOUNT HOLES 1/4".
CUT OUT AND BEND THE WING MOUNT AND ATTACH IT TO THE
WING WITH SERVO TAPE. YOU CAN USE SERVO TAPE TO ATTACH
THE MOUNT OR USE VELCRO.

INSTALL THE DRIVER FROM BELOW AND ATTACH LOWER PART
WITH TAPE.

MOUNT THE WINDSHIELD, HEADERS, AND INJECTORS WITH
SERVO TAPE.

