

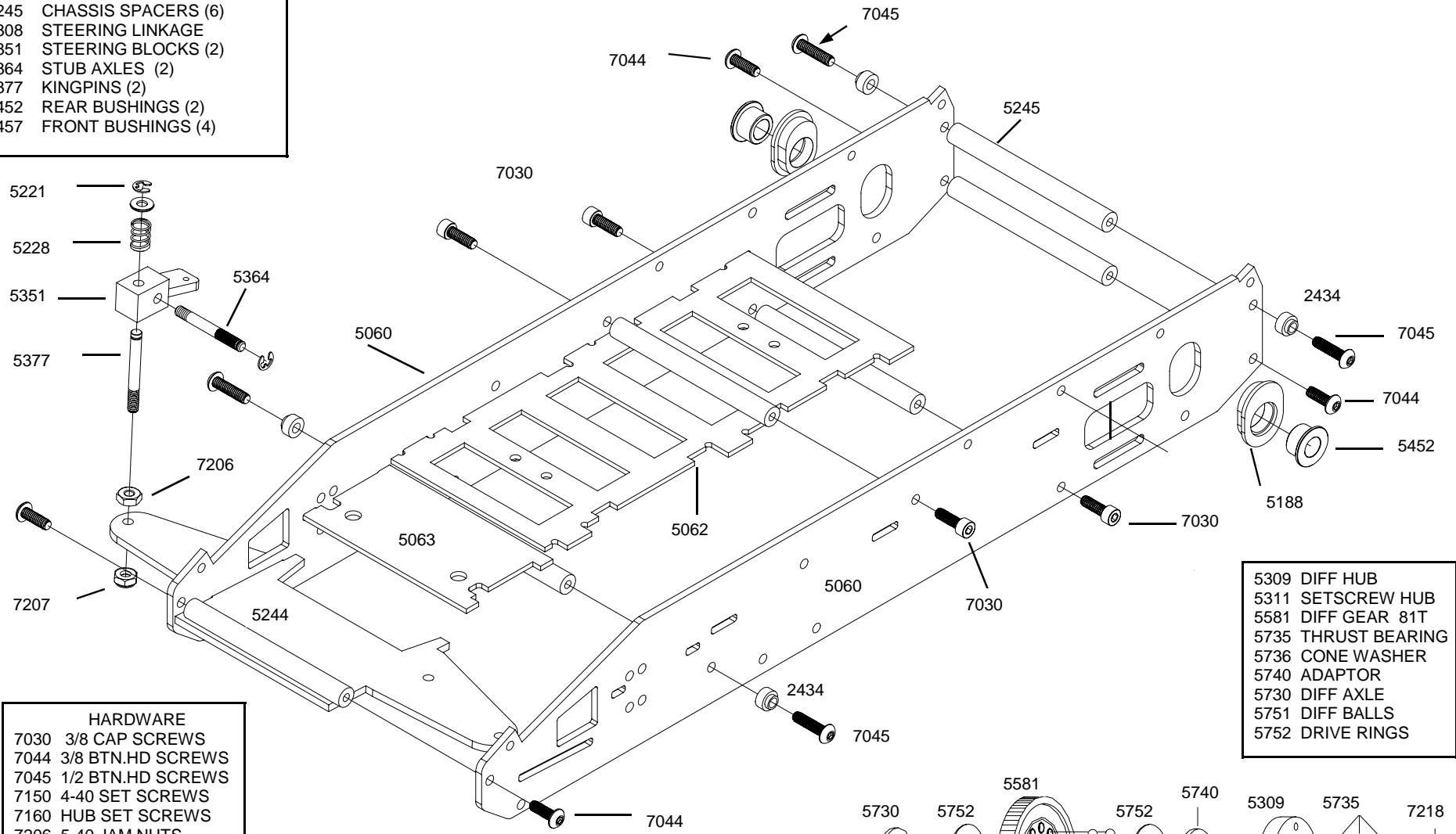

2032 CLASSIC SPRINT CAR

- REPLACEMENT PARTS**
- 2520 FRONT SPEC TIRES (2)
 - 2530 REAR SPEC TIRES (2)
 - 5060 CHASSIS SIDE
 - 5062 RADIO TRAY
 - 5063 SERVO PLATE
 - 5188 AXLE HEIGHT ADAPT (2 PR)
 - 5221 E-CLIPS (6)
 - 5228 FRONT SPRINGS (2)
 - 5244 FRONT AXLE PLATE
 - 5245 CHASSIS SPACERS (6)
 - 5308 STEERING LINKAGE
 - 5351 STEERING BLOCKS (2)
 - 5364 STUB AXLES (2)
 - 5377 KINGPINS (2)
 - 5452 REAR BUSHINGS (2)
 - 5457 FRONT BUSHINGS (4)

- 1047 INDY ROADSTER BODY KIT
- 1048 CLASSIC CHAMP CAR BODY KIT
- 2434 BODY MOUNTS (4 W/SCREWS)



- HARDWARE**
- 7030 3/8 CAP SCREWS
 - 7044 3/8 BTN.HD SCREWS
 - 7045 1/2 BTN.HD SCREWS
 - 7150 4-40 SET SCREWS
 - 7160 HUB SET SCREWS
 - 7206 5-40 JAM NUTS
 - 7207 5-40 LOCK NUTS
 - 7218 RED DIFF NUTS

- 5309 DIFF HUB
- 5311 SETSCREW HUB
- 5581 DIFF GEAR 81T
- 5735 THRUST BEARING
- 5736 CONE WASHER
- 5740 ADAPTOR
- 5750 DIFF AXLE
- 5751 DIFF BALLS
- 5752 DRIVE RINGS

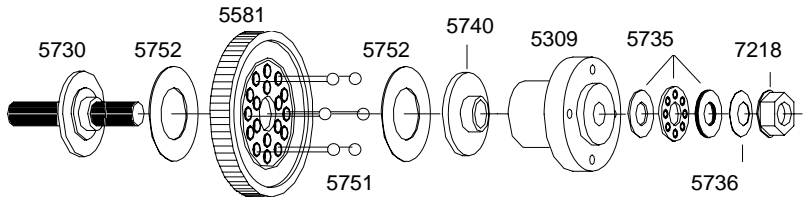

1047 INDY ROADSTER

PAINT THE BODY AND DRIVER. TRIM OUT AS SHOWN.
DRILL BODY MOUNT HOLES 1/4".

DRILL FOUR 1/8 HOLES AS MARKED AND ATTACH THE
ROLL BAR WITH FOUR SMALL SCREWS PROVIDED.

MOUNT THE WINDSHIELD , HEADERS , DRIVER, AND IN-
JECTORS WITH DOUBLE BACKED TAPE .

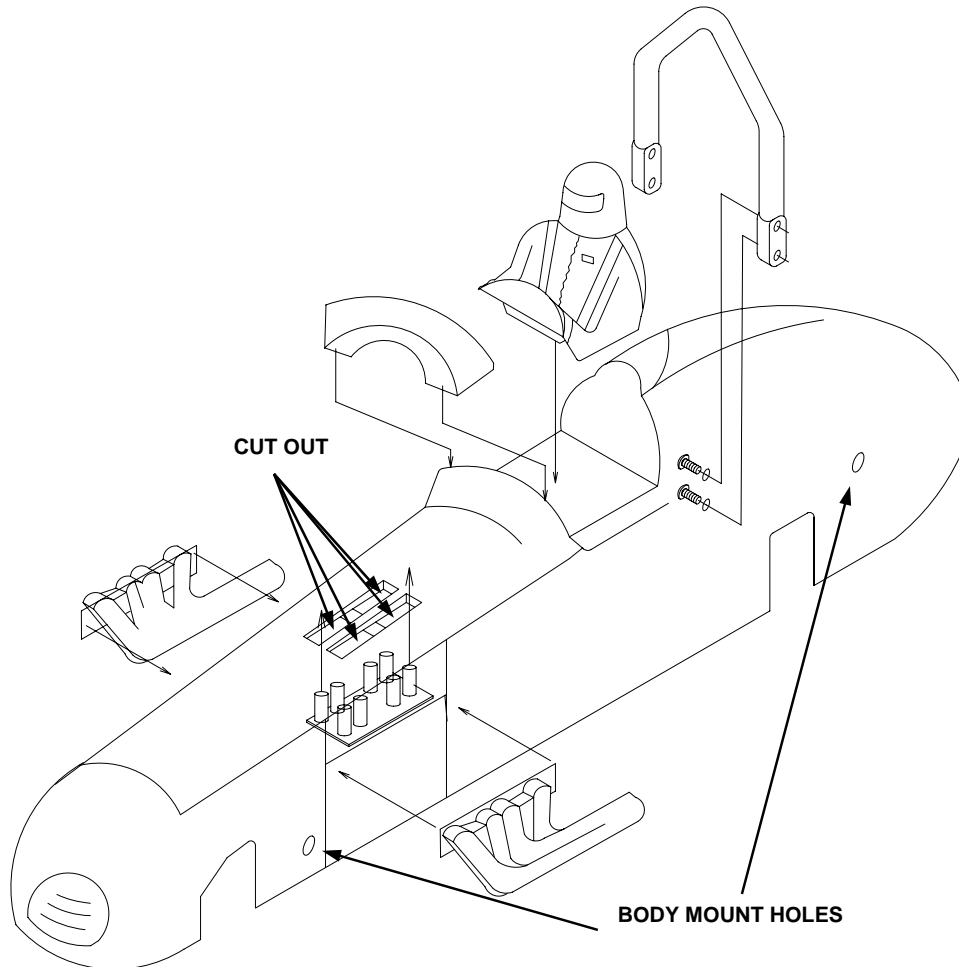

1048 CLASSIC CHAMP CAR

PAINT THE BODY AND DRIVER, AND WING IF YOU ARE GOING TO
USE IT. TRIM OUT AS SHOWN. DRILL BODY MOUNT HOLES 1/4".
CUT OUT AND BEND THE WING MOUNT AND ATTACH IT TO THE
WING WITH SERVO TAPE. YOU CAN USE SERVO TAPE TO ATTACH
THE MOUNT OR USE VELCRO .

INSTALL THE DRIVER FROM BELOW AND ATTACH LOWER PART
WITH TAPE.

MOUNT THE WINDSHIELD , HEADERS , AND INJECTORS WITH
SERVO TAPE .

